

**Specifications:**

**Material And Finish:**

Insulator:High Temp. Plastic(LCP UL94V-0

Insulator Color:Black

Contact:Phosphor Bronze

Body lock:Brass

Plated:Gold Plating on Contact and Tin Plating on Solder tail,over nickel Plating

**Rating:**

Current Rating:1.0 Amp

Voltage Rating:100V AC/DC

Operating Temperature Range:-40°~+105°C

**Electrical:**

Contact resistance:30m Ohm Max

Insulator resistance:1000M ohm min.

Withstanding Voltage:750V AC/Minute

**Ordering Information**

**ATAASS-22X-01-X**

1 2 3 4 5

- 1: — Series No.
- 2: — S:Striaght type
- 3: — No. of Positions
- 4: — H:Selective Gold Plated  
K:Selective Gold 5U”  
L:Selective Gold 10U”  
M:Selective Gold 15U”  
P:Selective Gold 30U”
- 5: — B:In Tube  
E:W/Cap In Tube

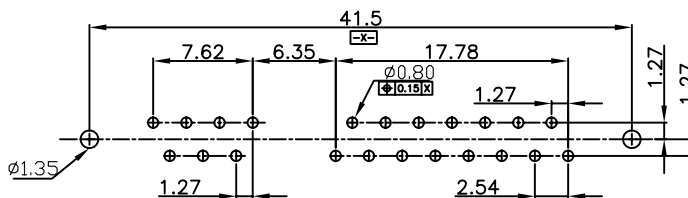
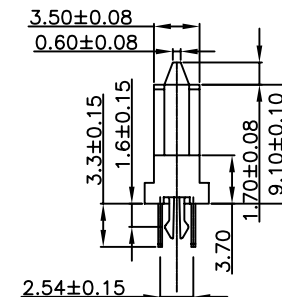
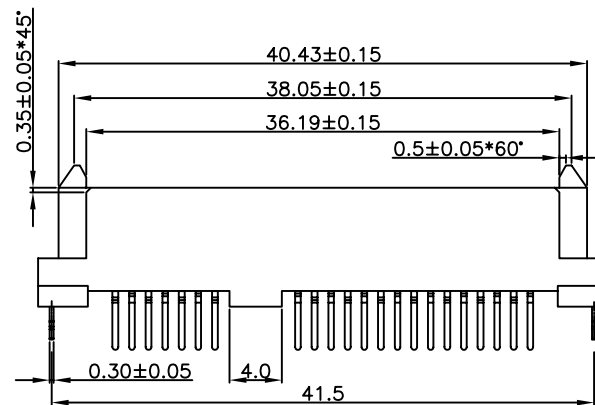
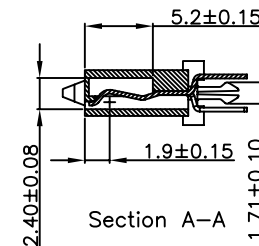
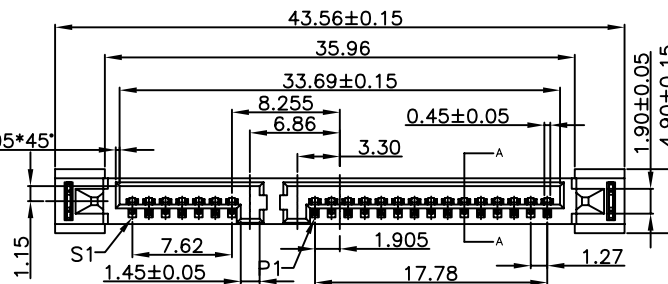

Recommended PCB Layout  
DEF AULT TOLERANCE:±0.05

RoHS Compliant

5X			
4X			
3X			
2X			
1X	ORIGINAL	joy chen	
REV	DESCRIPTION	DR.BY	ECN. NO.

DR.BY:	joy chen
CHKD.:	<i>jerry Liu</i>
APPD.:	<i>Peter Li</i>

GENERAL TOLERANCE:	
LINEAR	X: ±0.30
ANGLES	X': ±5.0°
	X.X: ±0.20
	X.XX: ±0.15
	X.XXX: ±0.10
	X.XX': ±3.0°
	X.XX': ±2.0°
	X.XXX': ±1.0°

**BRIGHT** 東莞市常平華晶電子廠  
Dong Guan Bright Electronic Factory

SHEET: 1/1  
SCALE: 1:1  
UNIT: mm

THIRD ANGLE PROJECTION

A4